

Features

- Stainless steel drainage pump
- Faster pumping
- Dual mechanical seal
- Thermal protection
- Float switch for single phase
- Motor protection IP68
- Insulation class F
- Maximum immersion depth 5m

Performance

- Capacity up to 54 m³/h
- Manometric Head up to 18 m
- Maximum content in sand 100 gr/m³

Applications

- Small tanks
- Garage
- Basement

Materials

- Motor casing made of stainl. steel AISI 304
- Shaft made of stainless steel AISI 304
- Impeller made of stainless steel AISI 304
- Pump casing made of stainl. steel AISI 304



ASTRA XB

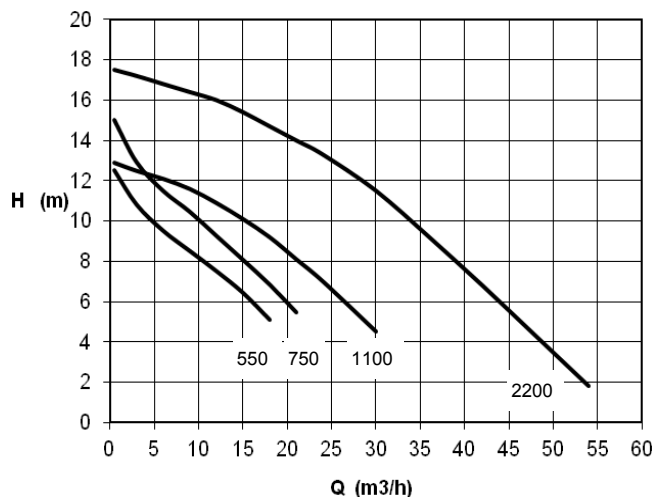

TYPE	VOLT	POWER KW	m ³ /h	0,5	6	12	18	24	30	42	54
				l/min	8,3	100	200	300	400	500	700
Astra XB 550	220V	0,55	H (m)	12,5	9,5	7,5	5,09				
Astra XB 750	220V	0,75		15	11,5	9,28	6,87				
Astra XB 1100	220V	1,1		12,9	12,1	10,9	9,2	7	4,5		
Astra XB 2200	400V	2,2		17,5	16,8	16	14,7	13,3	11,5	6,8	1,8

Dimensions

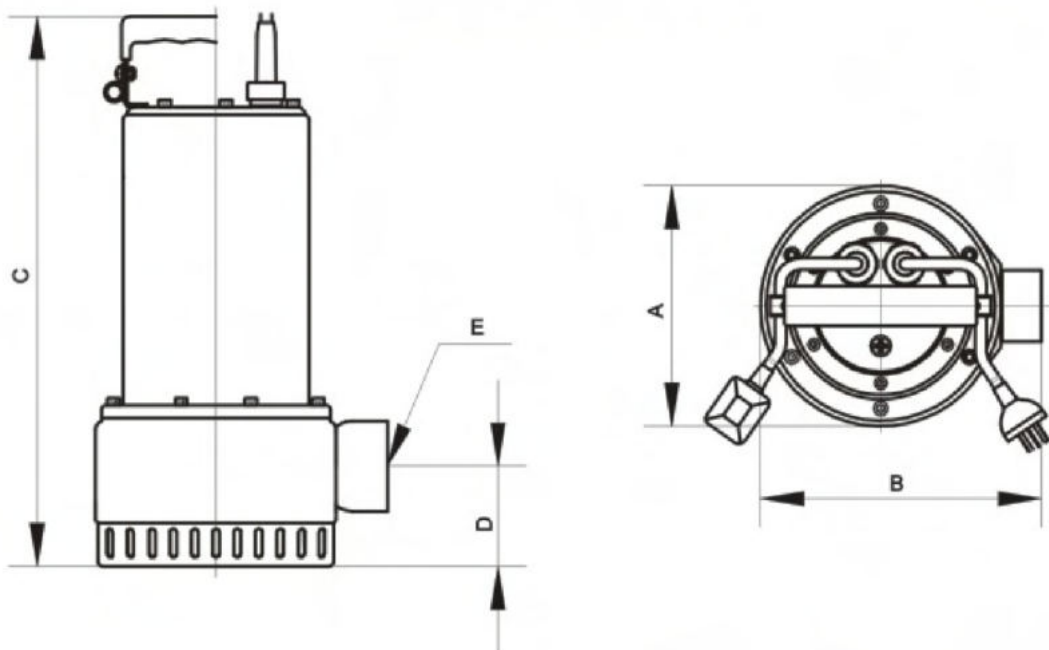

TYPE	A (mm)	B (mm)	C (mm)	D (mm)	E Discharge	Weight
Astra XB 550	170	195	360	68	1''1/2	12kg
Astra XB 750	170	195	385	68	1''1/2	14Kg
Astra XB 1100	170	210	385	68	2''	16Kg
Astra XB 2200	175	215	435	80	3''	21Kg