

### Features

- Light sewage water pump
- Grinding device to avoid clogging
- Dual mechanical seal
- Thermal protection
- Motor protection IP68
- Insulation class F
- Float switch only for single phase pumps
- Maximum immersion depth 5m

### Performance

- Capacity up to 15 m<sup>3</sup>/h
- Manometric Head up to 29m

### Applications

- Pumping of waste water
- Domestic use of sewage water
- Restaurants
- Hotels

### Materials

- Motor casing made of stainl. steel AISI 304
- Shaft made of stainless steel AISI 304
- Impeller made of cast iron
- Pump casing made of cast iron



### ARGO GX C

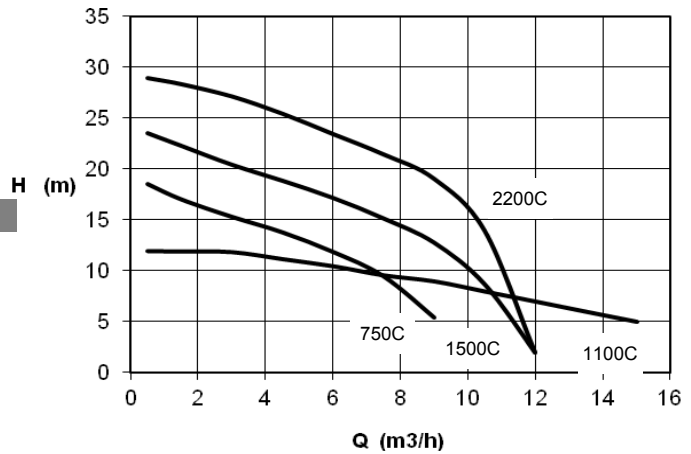

TYPE	VOLT	POWER KW	PARTICLES MAX DIAMETER	m <sup>3</sup> /h	0,5	1.5	3	4.5	6	7.5	9	10.5	12	15
					l/min	8,3	25	50	75	100	125	150	175	200
Argo GX 750C	220V 400V	0,75	Cutters	H (m)	18,5	17	15,3	13,78	11,9	9,5	5,5			
Argo GX 1100C	220V 400V	1,1	Cutters		12	11,9	11,8	11,2	10,5	9,6	9	8	7	5
Argo GX 1500C	220V 400V	1,5	Cutters		23,5	21,8	20,4	18,9	17,2	15,2	12,8	8,7	2	
Argo GX 2200C	400V	2,2	Cutters		29	28,4	27,2	25,5	23,5	21,5	19,1	14	2	

## Dimensions

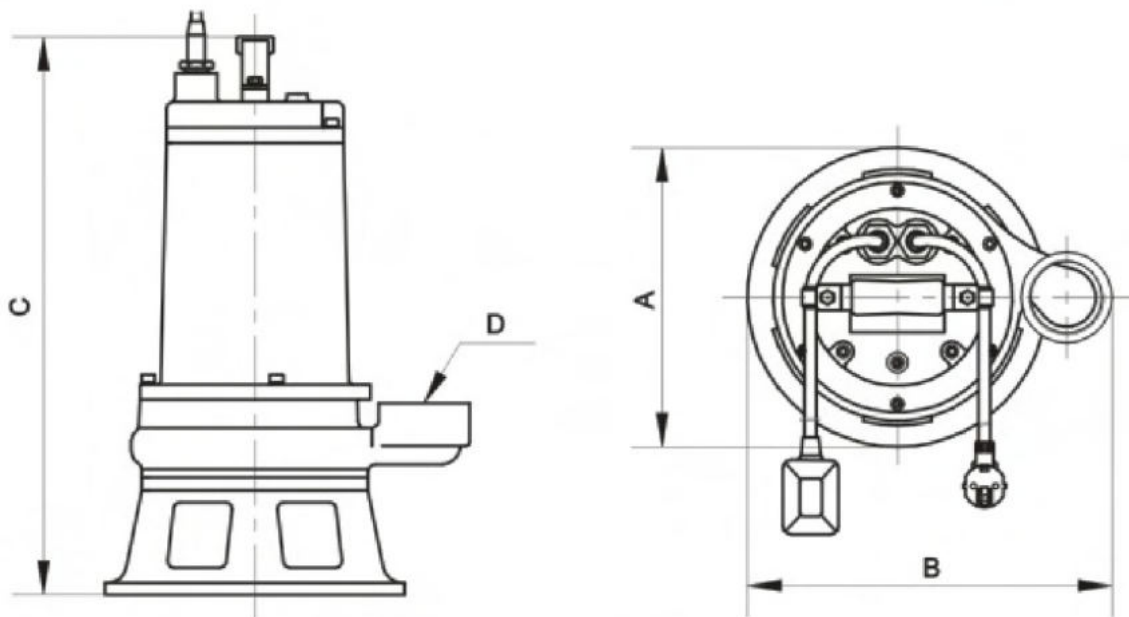

TYPE	A (mm)	B (mm)	C (mm)	D Discharge	Weight
Argo GX 750C	230	280	430	2"	30kg
Argo GX 1100C	190	270	450	2"	31kg
Argo GX 1500C	240	310	550	2"	36kg
Argo GX 2200C	240	310	550	2"	38kg